

BESPOKE CONCRETE

SPECIALISTS IN THE MANUFACTURE OF CUSTOM MADE PRE-CAST CONCRETE AND CAST STONE PRODUCTS

Bespoke Concrete Products Limited, Tynedale Works, Princess Way, Low Prudhoe, Northumberland NE42 6PL
t +44 (0) 1661 83 93 40 f +44 (0) 1661 83 39 23 e info@bespokeconcrete.co.uk w www.bespokeconcrete.co.uk

Case Study – Footbridge abutment units

Abutment units for a temporary footbridge.

The units for the project included:

- Abutment units

Footbridge abutment units

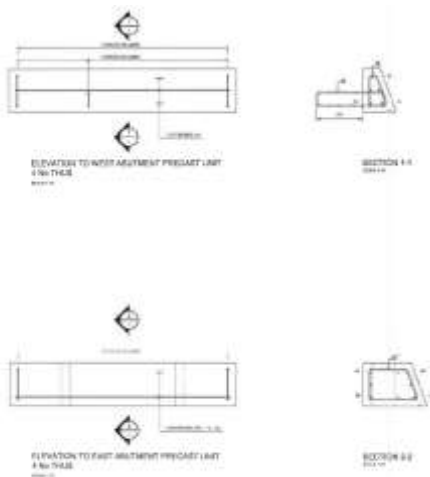

Bespoke Concrete Products Limited, VAT Number GB 605 5042 75, Registered in England number 2773783.
Registered address: Tynedale Works, Princess Way, Low Prudhoe, Northumberland NE42 6PL

Nitecrete Manufactured and developed by Bespoke Concrete Products Ltd. International Patent pending.

